

Latches with knob

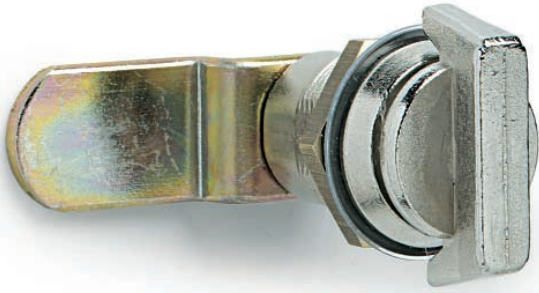

- Nickel-plated zinc alloy **body**.
- Nickel-plated zinc alloy **wing nut**.
- Assembly with **brass nut** M19x1, galvanised steel spring washer.
- **90° right rotation**.
- Galvanised and tropicalised steel **closing lever**, 2.5 mm thickness. Levers with other dimensions on request and for sufficient quantities.

Galvanised steel threaded extension for lever advanced positioning on request.

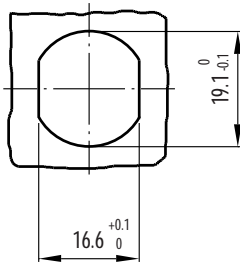

Drilling template

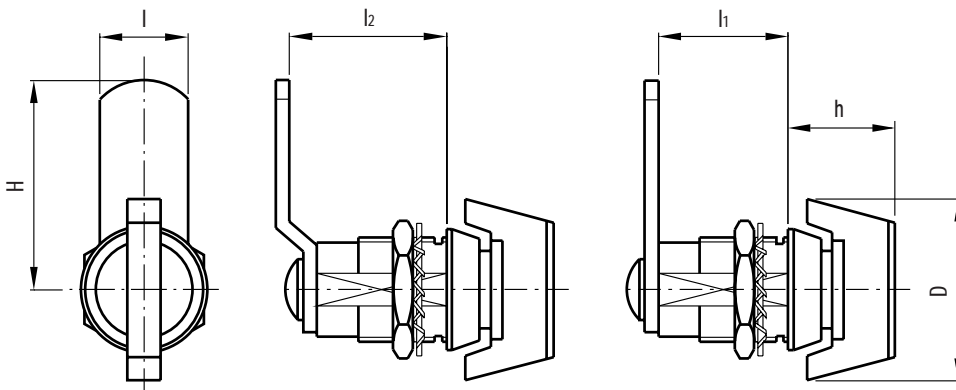

Standard elements		Main dimensions						Weight
Code	Description	D	h	l	l ₁	l ₂	H	grams
421211	CM.32	30	15	16	20	-	32	63
421213	CM.36-25					25	35.5	65