

MT-AT

ELESA Original design

Crank handles with revolving handle



Material

Glass-fibre reinforced polyamide based (PA) technopolymer. Resistant to solvents, oils, greases and other chemical agents.

Colour

Black, matte finish.

Assembly

H7 reamed black-oxide steel boss.

Revolving handle

Type I.621+x polyamide based (PA) technopolymer, black colour, matte finish, non-dismountable.

Features and applications

The reticular structure of the crank arm and the technopolymer used make this handle very strong and therefore suitable for transmitting high torque values.

Special executions on request (for sufficient quantities)

Threaded brass boss.

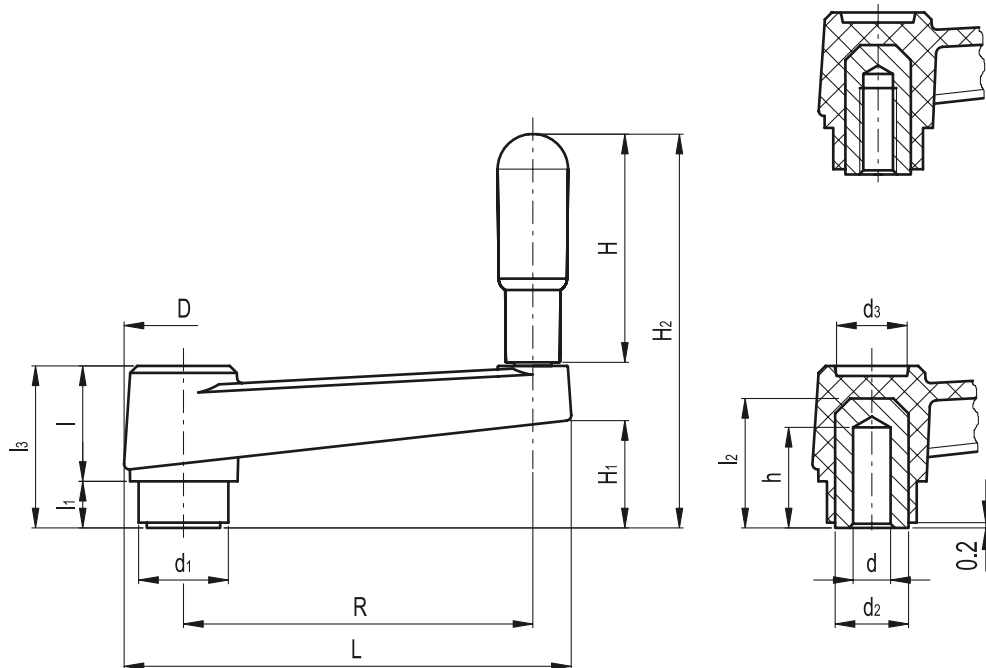

Standard Elements		Main dimensions										Mounting hole		Handle	△		
Code	Description	R	L	D	d ₁	d ₃	l	l ₁	l ₃	d ₂	l ₂	H ₁	H ₂	d H7	h	H	g
44053	MT.50-AT	50	69	23	18	13	21	9	30	15	23	20.5	66	6	18	35	45
44113	MT.64-AT	64	86	27	20	16	23	9	32	15	25	18.5	78	8	20	45	65
44213	MT.80-AT	80	105	30	23.5	17	26	10	36	18	31	23	98	10	25	60	95
44313	MT.100-AT	100	128	34	24	21	30	10	40	18	31	24.5	106	12	24	65	160
44413	MT.130-AT	130	162	40	34	25	35	14	49	26	43	34	116	14	30	65	220
44513	MT.160-AT	160	197	45	34	27	40	15	55	26	43	38	137	16	30	80	300



eleSA-GANTER

ELESA and GANTERGRIF models all rights reserved in accordance with the law. Always mention the source when reproducing our drawings.