

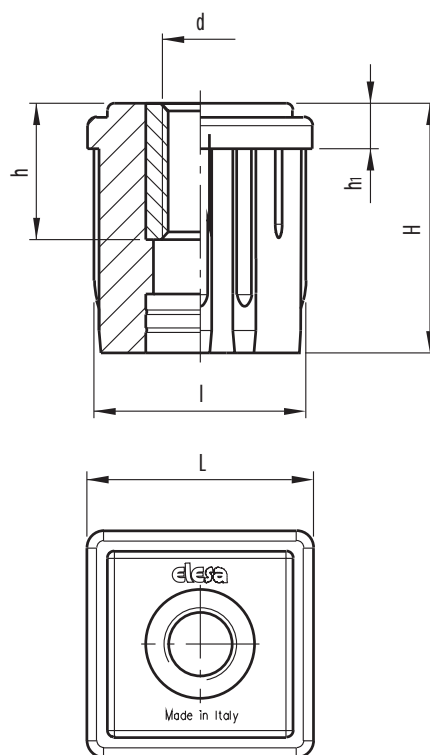

Square end-caps

- **Glass-fibre reinforced polyamide-based (PA) technopolymer.** Resistant to solvents, oil, greases and other chemical agents.
- **Black** standard colour with matte finish.
- Brass nickel-plated **threaded bushing**.
- **Maximum static load** 5000 N. It means the value over which the applied load to the element, in certain conditions of use, may cause plastic material deformation.

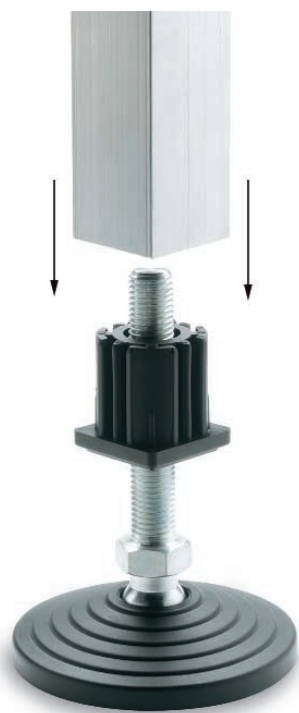

Standard elements		Main dimensions				Mounting hole		Tube dimensions			Weight
Code	Description	L	H	h ₁	l	d	h	External	Thickness	Internal	grams
319103	ND.Q-30x1.5-M10	30	33	6	27.5	M10	20	30	1.5	27	56
319104	ND.Q-30x1.5-M12					M12					
319106	ND.Q-30x1.5-M16					M16					
319263	ND.Q-40x2-M10	40	43	8	36.5	M10	20	40	2	36	85
319264	ND.Q-40x2-M12					M12					
319266	ND.Q-40x2-M16					M16					
319354	ND.Q-50x2-M16	50	55	10	46.5	M16	30	50	2	46	156
319356	ND.Q-50x2-M20					M20					132
319364	ND.Q-50x2.5-M16	50	55	10	45.5	M16	30	50	2.5	45	152
319366	ND.Q-50x2.5-M20					M20					128