

Latch-type knobs

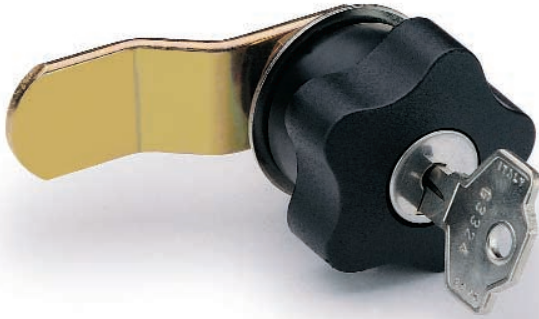

- **High impact strength polypropylene-based (PP) technopolymer knob.** Resistant to solvents, oils, greases and other chemical agents.
- **Black** standard colour with matte finish.
- **Lock** incorporated, stainless steel front plate. Locking movement 90°, opening to left (**S**) or right side (**D**).

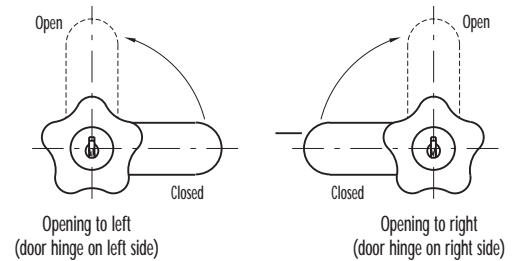

- Two nickel-plated **brass keys**, removable from two 180° positions (locked-unlocked).
- Tropicalised zinc-plated **steel latch** 90° opening closing movement.
- **Type VC.** lock with different numbers (400 different combinations).
- **Type VC.U** lock with same numbering.
- **Type VC.M** lock (160 different combinations) with master key (passepartout).
- **Type VC.SS** without lock. Knob opens both to the right and left.



Special type (on request and for sufficient quantities) with threaded extension to position the latch when $l > 18$ mm.

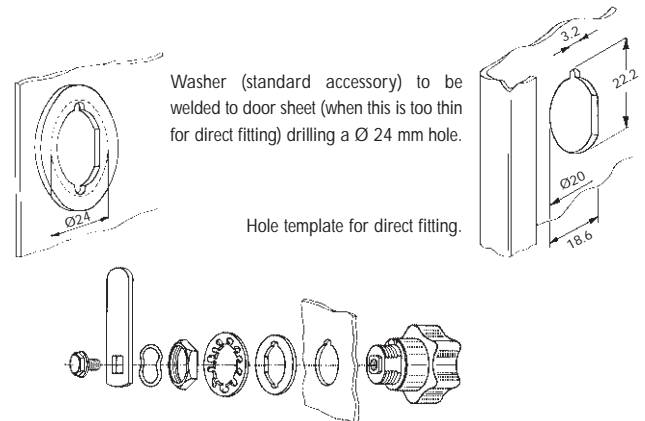
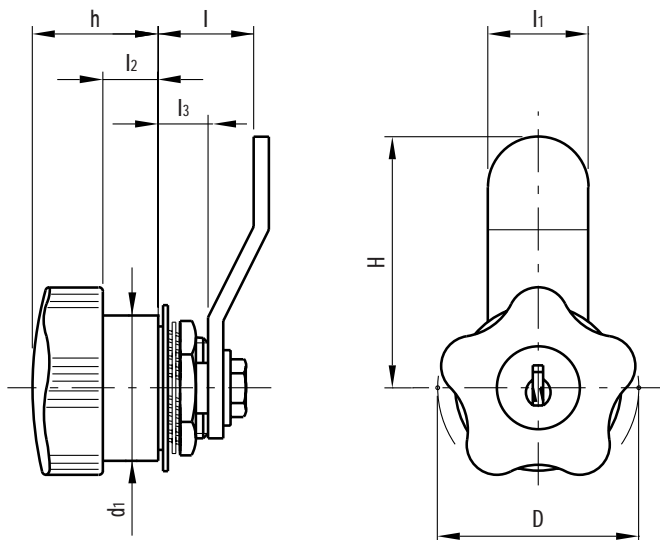

| Standard elements | | Main dimensions | | | | | | | | Weight |
|-------------------|--------------|-----------------|----|----|-------------|----|----|----|----|--------|
| Code | Description | D | h | d1 | $l \pm 0.5$ | l1 | l2 | l3 | H | grams |
| 68121 | VC.309/40-D | 40 | 25 | 29 | 18 | 20 | 11 | 10 | 48 | 146 |
| 68122 | VC.309/40-S | | | | | | | | | 146 |
| 68123 | VC.309/40-UD | | | | | | | | | 146 |
| 68124 | VC.309/40-US | | | | | | | | | 146 |
| 68125 | VC.309/40-MD | | | | | | | | | 146 |
| 68126 | VC.309/40-MS | | | | | | | | | 146 |
| 68131 | VC.309/40-SS | | | | | | | | | 115 |