

Solid handwheels with safety fold-away handle



- **High-impact strength polypropylene-based (PP) technopolymer.**

Resistant to solvents, oils, greases and other chemical agents.

- **Black** standard colour with matte finish.

- Black oxide **steel boss** with standard H7 tolerance reamed holes.

- Light-grey acetal resin based (POM) technopolymer push-fit **boss cap** removable by pressing on outer edge.

- Technopolymer Fold-O-matic® safety **fold-away handle** type IRS.802.

- **Rear finger grips.**

- **Axial retaining washer** (on request) type GN 184 (page 452).



This product has been selected for its design by the international jury of "Die gute Industrieform-Hannover 1985"



This product has been selected for its design by the international jury of "XIV PREMIO Compasso d'oro-Milano 1987"

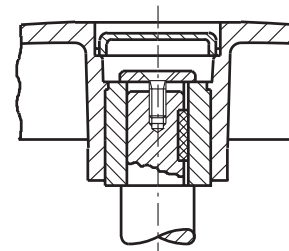
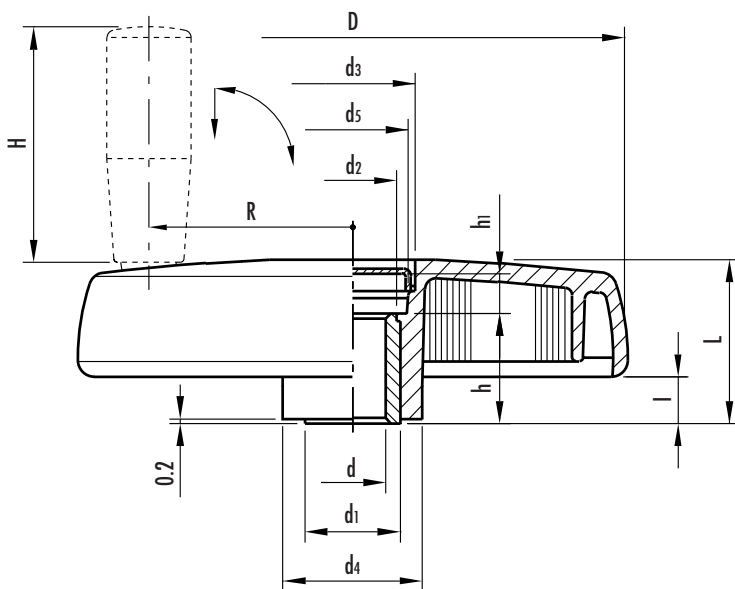

Assembly example with key and axial set screw

See Technical Data for maximum applicable torque (C) and impact strength (L).

Standard elements		Main dimensions									Bore		Handle		C	L	Weight
Code	Description	D	L	l	d1	d2	d3	d4	d5	h1	d H7	h	H	R	[N•m]	[J]	grams
72771	VDS.150+IRS A-14	150	44	12	26	24	34	38	30	10	14	30	65	58	180	15	445
72772	VDS.150+IRS A-16										16						
72821	VDS.175+IRS A-16	176	49	13	35	33	39	44	35	16	16	28	80	70	195	20	525
72822	VDS.175+IRS A-20										20						
72871	VDS.200+IRS A-20	200	53	14	40	38	44	50	40	13	20	36	90	81	320	27	730
72872	VDS.200+IRS A-24										24						
72931	VDS.250+IRS A-20	250	60	17	40	38	50	57	48	19	20	36	90	104	500	30	955
72981	VDS.300+IRS A-20	300	66	20	40	36.5	68.5	72	66	20	20	44	90	124	500	30	1285