

VRTP+IEL

ELESA original design

Two-spoke handwheels with revolving handle

- **High-impact strength polypropylene-based (PP) technopolymer.**
Resistant to solvents, oils, greases and other chemical agents.
- **Black** standard colour with matte finish.
- Black oxide **steel boss** with standard H7 tolerance reamed holes.
- Self-adhesive, matte anodised **aluminium central plate** for fitting after handwheel assembly.
- **Revolving handle** type IEL+x (see page 248) in black thermoplastic elastomer (TPE) with matte finish.
- **Ergonomically shaped rim** for a safer and more comfortable grip.
- **Axial retaining washer** (on request) type GN 184 (page 452).



Operating elements

1
42



This product has been selected for its design by the international jury of "Die gute Industrieform-Hannover 1981"

design81



This product has been selected for its design by the international jury of "Design 1981-Stuttgart"

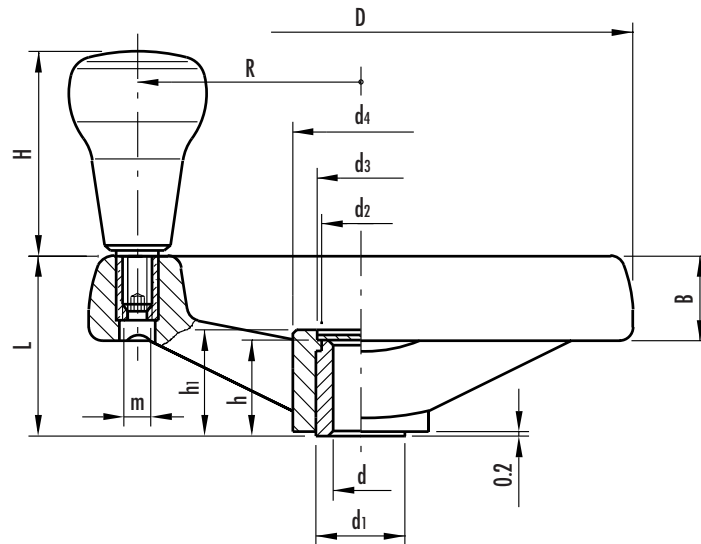

See Technical Data for maximum applicable torque (C) and impact strength (L).

Standard elements		Main dimensions								Bore		Handle			C	L	Weight
Code	Description	D	L	B	d1	d2	d3	d4	h1	d H7	h	H	m	R	[N•m]	[J]	grams
78926 78928	VRTP.250 + IEL A-20 VRTP.250 + IEL A-24	249	70	32	35	33	34	59	40	20 24	38	65	M10	105	420	28	914 818
78964 78966	VRTP.300 + IEL A-20 VRTP.300 + IEL A-26	298	78	36	40	37	42	66	46	20 26	43	65	M10	127	480	36	1060 1121
79026	VRTP.375 + IEL A-26	373	82	38	40	37	42	69	46	26	43	65	M10	162	480	40	1355



"ELESA" and "GANTERGRIFF" models all rights reserved in accordance with the law. Always mention the source when reproducing our drawings.