



Two-spoke handwheels with fold-away handle

- **High-impact strength polypropylene-based (PP) technopolymer.**
Resistant to solvents, oils, greases and other chemical agents.
- **Black** standard colour with matte finish.
- Black oxide **steel boss** with standard H7 tolerance reamed holes.
- Self-adhesive, matte anodised **aluminium central plate** for fitting after handwheel assembly.
- Technopolymer **fold-away handle** type IR.612.
- **Ergonomically shaped rim** for a safer and more comfortable grip.
- **Axial retaining washer** (on request) type GN 184 (page 452).



This product has been selected for its design by the international jury of "Die gute Industrieform-Hannover 1981"

design81



This product has been selected for its design by the international jury of "Design 1981-Stuttgart"

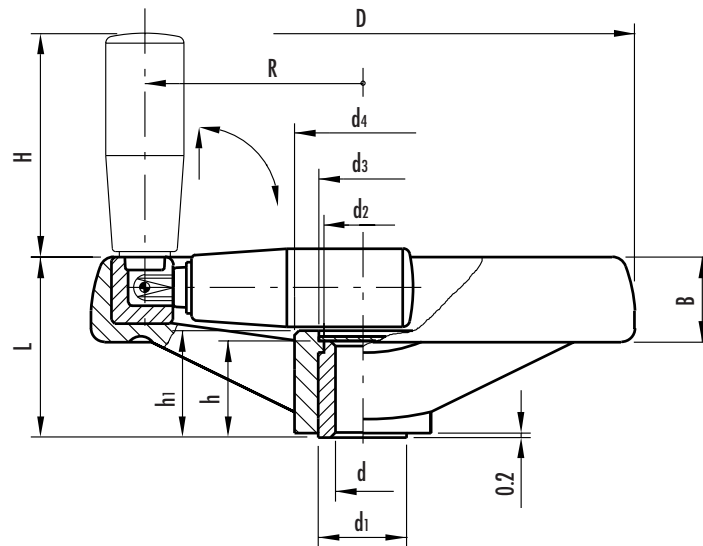

See Technical Data for maximum applicable torque (C) and impact strength (L).

Standard elements		Main dimensions								Bore		Handle		C	L	Weight
Code	Description	D	L	B	d1	d2	d3	d4	h1	d H7	h	H	R	[N·m]	[J]	grams
78431 78432	VRTP.80+IR A-8 VRTP.80+IR A-10	80	35	18	18	16	17	23	19	8 10	17	50	29	32	5	102 98
78531 78532	VRTP.100+IR A-10 VRTP.100+IR A-12	99	37	20	18	16	17	25	19	10 12	17	56	37	54	7	163 155
78631 78632	VRTP.125+IR A-12 VRTP.125+IR A-14	124	44	22	22	20	21	31	25	12 14	22	65	48	94	10	230 225
78731 78732	VRTP.160+IR A-14 VRTP.160+IR A-16	160	51	25	26	24	25	40	29	14 16	27	65	65	185	15	388 380
78831 78833	VRTP.200+IR A-16 VRTP.200+IR A-20	200	61	28	30	28	31	50	36	16 20	34	80	84	300	24	593 560
78931 78933	VRTP.250+IR A-20 VRTP.250+IR A-24	249	70	32	35	33	34	59	40	20 24	38	90	105	420	28	932 892
78968 78971	VRTP.300+IR A-20 VRTP.300+IR A-26	298	78	36	40	37	42	66	46	20 26	43	90	127	480	36	1080 1210
79031	VRTP.375+IR A-26	373	82	38	40	37	42	69	46	26	43	90	162	480	40	1432