

Three-spoke handwheels with revolving handle

- **High strength, reinforced, phenolic-based (PF) Duroplast.**
Resistant to solvents, oils, greases and other chemical agents.
- **Black** standard colour with glossy finish.
- **Large diameter black oxide steel boss** with uncovered front end and blind hole.
- Duroplast **revolving handle** type I.301+x (page 267).
- **Axial retaining washer** (on request) type GN 184 (page 452).

Special types and applications

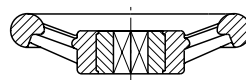

Square through hole

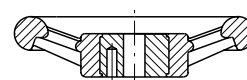

Drive hole

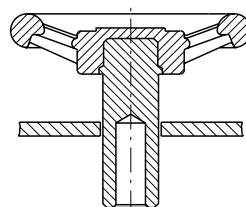

Extended boss for bulkhead assembly

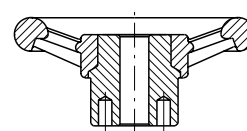

Extended boss and spring-loaded ball locking mechanism

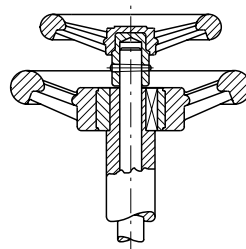

Controlling coaxial shafts

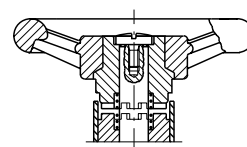

Extended boss and claw coupling

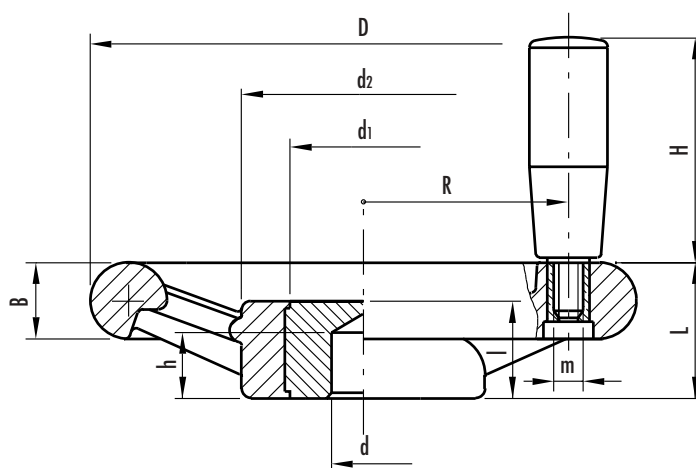

See Technical Data for maximum applicable torque (C) and impact strength (L).

Standard elements		Main dimensions						Hole dimensions		Handle			C	L	Weight
Code	Description	D	L	B	d ₁	d ₂	l	d H ₉	h	H	m	R	[N•m]	[J]	grams
80011	VRU.125+I	125	28	18	32	55	22	10	15	65	M8	47	220	9	400
80111	VRU.160+I	160	35	22	42	70	26	10	17	65	M8	60	350	13	700
80211	VRU.200+I	199	40	26	53	85	27	12	20	80	M10	75	450	20	1130
80311	VRU.250+I	249	49	30	68	105	30	12	22	80	M10	99	650	25	1910