

## Balanced handles

- **Zinc alloy die-cast** RAL 9005 black epoxy resin coating with matte finish.
- **Hub** with standard H7 tolerance reamed blind hole
- Black polyamide based (PA) technopolymer **revolving handle**. Resistant to solvents, oils, greases and other chemical agents.

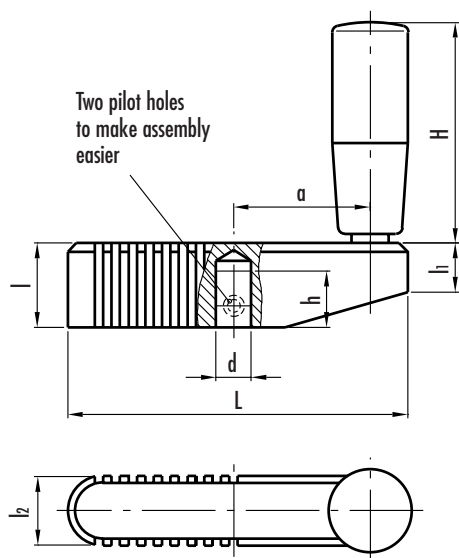

This product has been selected for its design by the international jury of "Die gute Industrieform-Hannover 1987"



Standard elements	Main dimensions					Mounting hole	Handle		Weight
Description	L	l	l1	l2	a	d H7	h	H Ø	grams
GN 112.1-70-S8	70	19	11.5	17	26.5	8	12	42.5 18	125
GN 112.1-80-S8	80	21	12.5	18	31	8	12	52.5 21	170
GN 112.1-90-S10	90	23	13.5	19	35.5	10	15	52.5 21	251
GN 112.1-100-S10	100	25	14	20	40	10	17	67.5 23	290
GN 112.1-100-S12	100	25	14	20	40	12	17	67.5 23	285

## Tri-ball handles

- **Turned and polished steel arm.**
- **Passing through hole** with H7 tolerance.
- Available with DIN 39 steel fixed handle (see page 271).

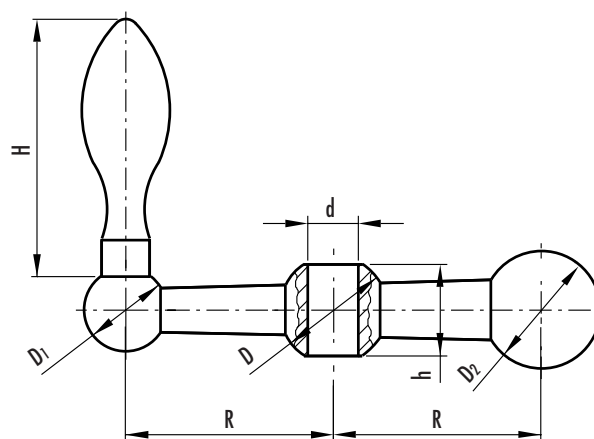

Standard elements	Main dimensions				Mounting hole	Handle			Weight
Description	D	D1	D2	h	d H7	H Ø	R	grams	
GN 10-100-B7-F	16	13	18	13	7	32 10	25	60	
GN 10-101-B8-F	19	15	20	17	8	40 13	28	102	
GN 10-102-B8-F	20	16	22	17	8	45 14	34	136	
GN 10-103-B10-F	23	18	25	19.5	10	50 16	41	194	
GN 10-104-B12-F	26	20	28	21.5	12	56 18	50	283	