

GN 736

Control handwheels

- **Black anodised aluminium** with knurled surface.
- Light grey acetal resin based (POM) technopolymer **boss cap**.
- Black polyamide based (PA) technopolymer revolving **handle** (type D) or without handle (type A).
- Standard H8 tolerance reamed plain **hole** (bore type B) or with DIN 6885/1 P9 keyway (type code K).

For fixing GN 736 on shafts by a grub screw see GN 110 drilling technical information on page 668.



This product has been selected for its design by the international jury of "Die gute Industrieform-Hannover 1988"

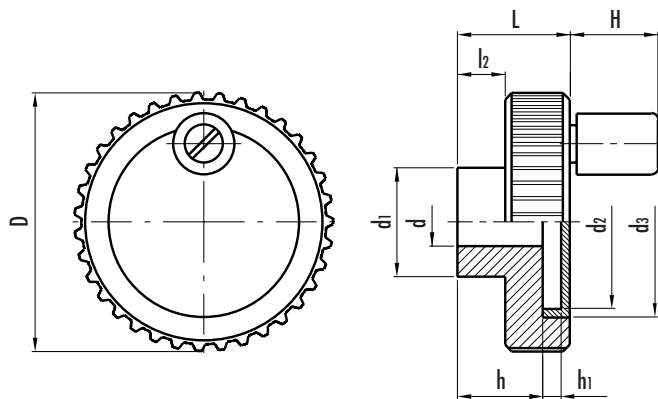

Standard elements	Main dimensions							Mounting hole		Handle	Weight
	D	L	l ₂	d ₁	d ₂	d ₃	h ₁	d H8	h	H	grams
GN 736-52-B10-A GN 736-52-B10-D	52	23	10	22	37	39.5	3.8	10	17	- 18	56 69
GN 736-62-B10-A GN 736-62-B10-D	62	23	10	25	47	49.5	3.8	10	17	- 20	76 90
GN 736-52-K10-A GN 736-52-K10-D	52	23	10	22	37	39.5	3.8	10	17	- 18	55 68
GN 736-62-K10-A GN 736-62-K10-D	62	23	10	25	47	49.5	3.8	10	17	- 20	75 89